

Heat-Flo, Inc.

Top of Tank Connections

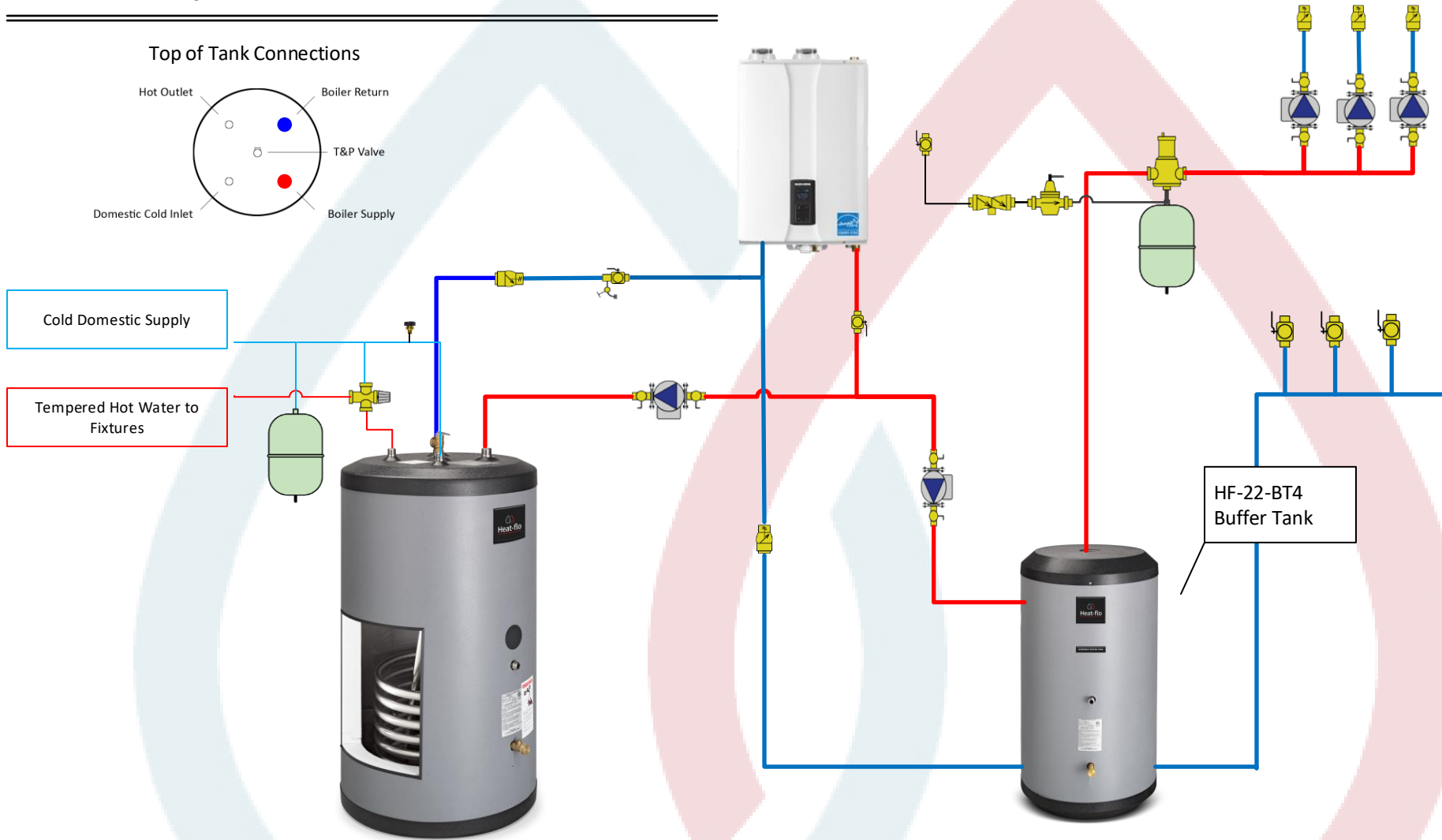
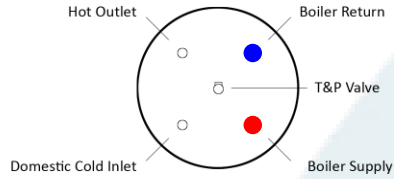

DISCLAIMER

This drawing shows system piping concept only. Installer is responsible for all equipment and detailing required by local codes.

Size header piping for maximum flow velocity of 2 feet/ second.

All other piping should be sized for a maximum flow velocity of 4 feet/ second.

Install a minimum of 12 diameters of straight pipe upstream of all circulators and check valves.

Install isolating flanges or isolating valves on all circulators.

Install purging valve(s) on all circuits.

All closely spaced tees shall be within 4 pipe diameter center to center spacing.

Install minimum of 6 pipe diameters of straight pipe upstream and downstream of all closely spaced tees.

Differential pressure bypass valve prevents flow noise under partial load conditions (some zone valves closed).

Set differential pressure bypass valve to delta P of distribution system with all zones open +1 psi.

Heat-Flo, Inc.

Heat-Flo Indirect Water Heater and Buffer Tank w/ Navien Boiler

Suffix on HF 22 ONLY: BT-2 has 2 tappings
BT-4 has 4 tappings

ALL OTHER BUFFER TANKS:
Suffix: 114 indicates 1 ¼ inch tappings
112 indicates 1 ½ inch tappings
2 indicates 2 inch tappings

Model	Storage Volume (Gal.)	Dimensions (Inches)				Piping Connections (NPT)	Max. Tank Working Pressure (psi)	Approx. Shipping Wt. (Lbs.)
		A. (Ht.)	B.	C.	D. (Dia.)			
HF-22-BT-2	22	24.5	—	8.0	22.5	1-1/4"	60	35
HF-22-BT-4	22	24.5	15	8.0	22.5	1-1/4"	60	35
HF-40-BT-114	40	42.0	31.0	11.0	23.5	1-1/4"	60	87
HF-40-BT-112	40	42.0	31.0	11.0	23.5	1-1/2"	60	87
HF-40-BT-2	40	42.0	31.0	11.0	23.5	2"	60	87
HF-60-BT-114	60	44.0	31.5	11.5	28.0	1-1/4"	60	115
HF-60-BT-112	60	44.0	31.5	11.5	28.0	1-1/2"	60	115
HF-60-BT-2	60	44.0	31.5	11.5	28.0	2"	60	115
HF-80-BT-114	80	54.0	40.5	11.5	28.0	1-1/4"	60	125
HF-80-BT-112	80	54.0	40.5	11.5	28.0	1-1/2"	60	125
HF-80-BT-2	80	54.0	40.5	11.5	28.0	2"	60	125
HF-115-BT-114	115	72.0	61.5	11.5	28.0	1-1/4"	60	160
HF-115-BT-112	115	72.0	61.5	11.5	28.0	1-1/2"	60	160
HF-115-BT-2	115	72.0	61.5	11.5	28.0	2"	60	160

DISCLAIMER

This drawing shows system piping concept only. Installer is responsible for all equipment and detailing required by local codes.
Size header piping for maximum flow velocity of 2 feet/ second.
All other piping should be sized for a maximum flow velocity of 4 feet/ second.
Install a minimum of 12 diameters of straight pipe upstream of all circulators and check valves.
Install isolating flanges or isolating valves on all circulators.
Install purging valve(s) on all circuits.
All closely spaced tees shall be within 4 pipe diameter center to center spacing.
Install minimum of 6 pipe diameters of straight pipe upstream and downstream of all closely spaced tees.
Differential pressure bypass valve prevents flow noise under partial load conditions (some zone valves closed).
Set differential pressure bypass valve to delta P of distribution system with all zones open +1 psi.